

Electric Actuators NEW STEPTOP

The era of electric control valves has come

M-System has launched NEW linear motion type electric actuator STEPTOP (Model: MSP10) to achieve carbon neutrality, which is becoming increasingly important. We hope that this electric actuator that flexibly controls the latest stepping motor using a one-chip CPU, will materialize both convenience and energy saving in your equipment at the same time.

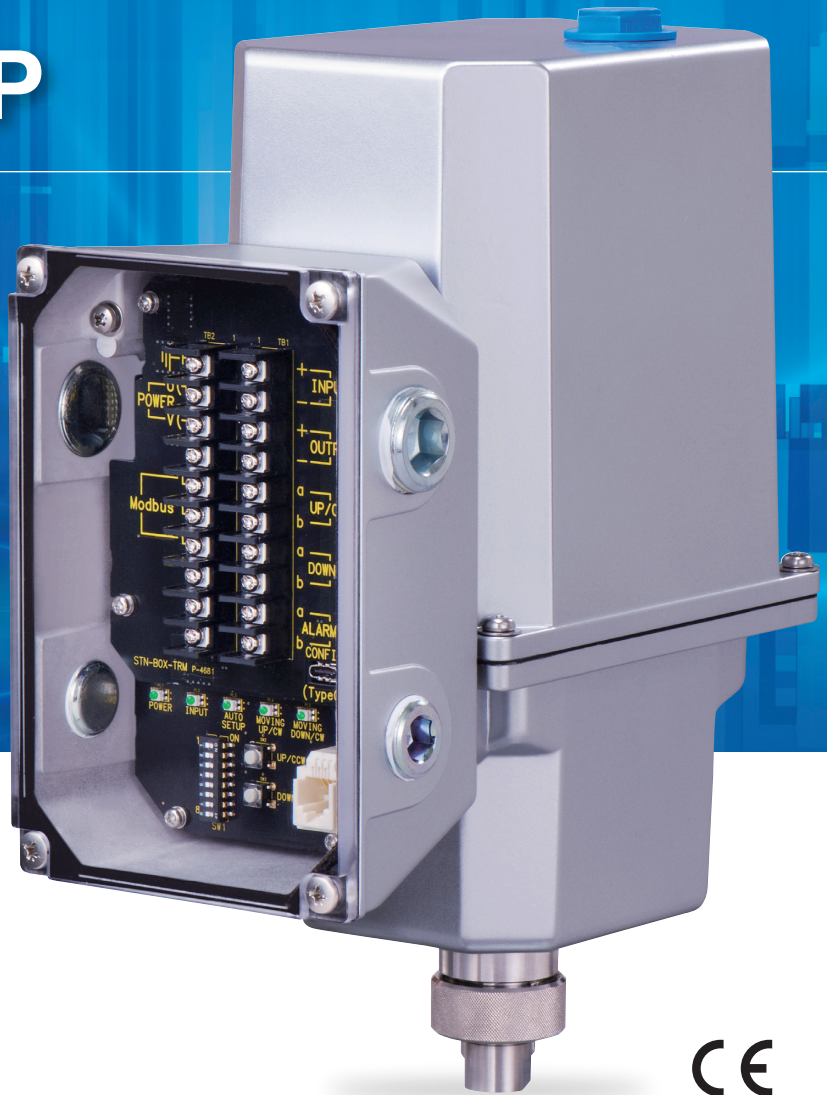

NEW

Model : MSP10



IP66



Contribute to carbon neutrality

- No air source equipment is required
- Zero emission
- Significant energy savings

STEPTOP

Auto-setup function as standard feature

- The time and effort required to adjust the opening angle is greatly reduced.
- It also reduces the time and effort required for maintenance work after operation.

Modbus communication^(*) as standard equipment

- Directly connectable to PLC/PC network

Stepping motor is a dopted as the drive source

- Compact and high-torque
- High resolution exceeding 1 /1000 is realized
- High torque and high speed operation time

(*) Modbus is a communication protocol developed by Modicon (Currently known as Schneider Electric) for PLCs. Modbus is an open network whose specifications are open to the public worldwide, and is widely used in the fields of FA and PA.

M-SYSTEM CO., LTD.

All control circuits are housed in a terminal box

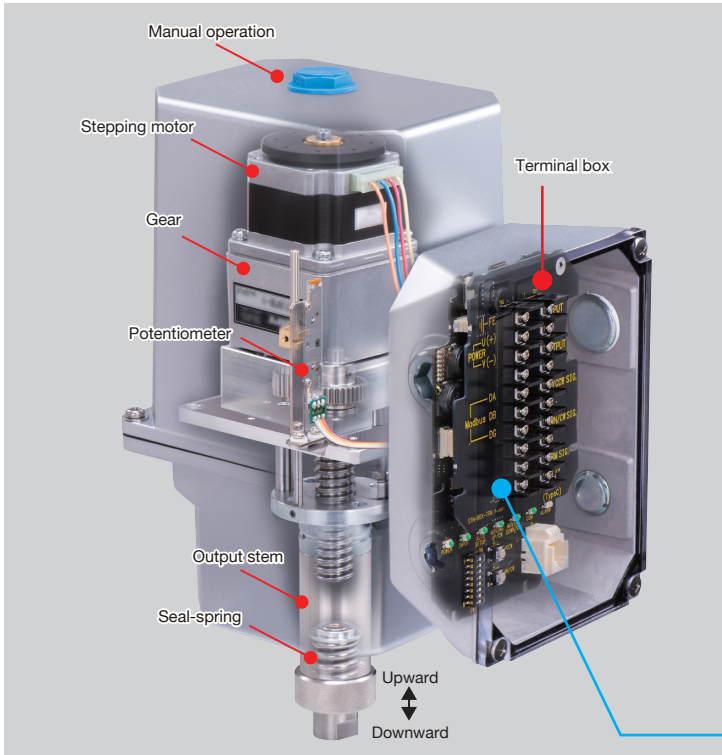

Status indicator LED

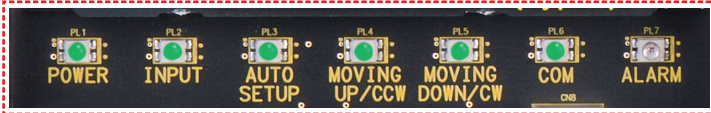

Easy parameter setting

Various parameters can be set from the DIP switches in the terminal box or from the programming unit (PU-2A) connected to the modular jack without opening the cover of the STEPTOP main body. In addition, parameters can also be set from a PC using the configurator software (Model: STCFG). (*2)

(*2) The configurator software (Model: STCFG) can be downloaded for free from the M-System Web site.

Easy to do wiring

The terminal box is independent of the main unit to make wiring work easier.

Operation can be checked at a glance

The terminal box cover is made of strong, transparent polycarbonate, and the LEDs for operating status indication can be seen from the outside.

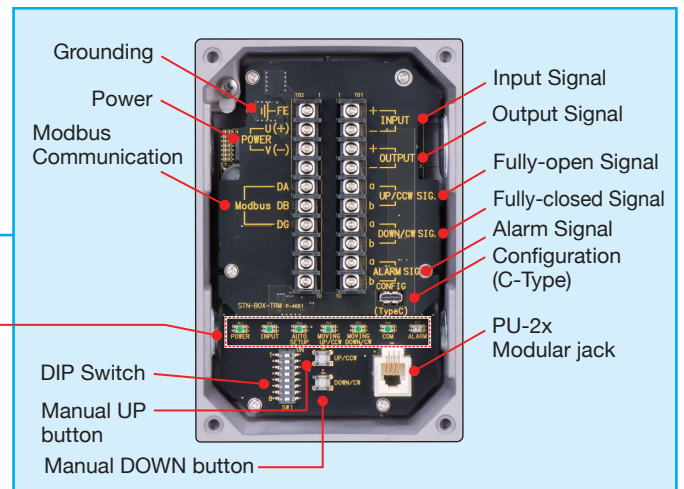

Thrust 100~2500N

Stroke 10~40mm

Thrust / Operation time

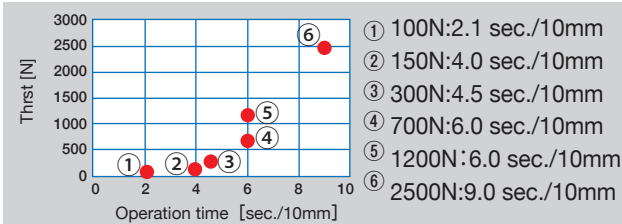

Output stem operation distance

- 10mm
- 15mm
- 20mm
- 40mm

General Specifications

- Position detection : Conductive potentiometer
- Input signal : 4-20mA DC or 1-5V DC, Modbus-RTU
- Power supply
 - AC power : 100-120V AC, 200-240V AC
 - DC power : 24V DC
- Degree of protection : IP66

External Dimensions

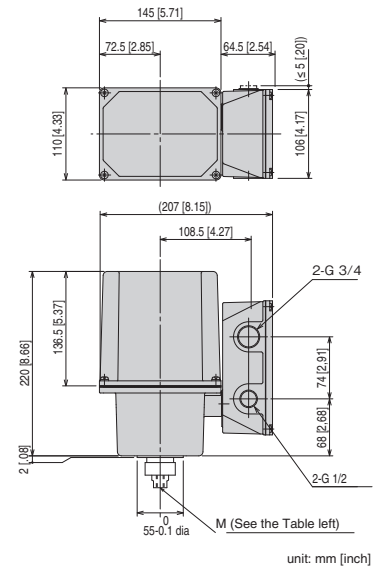

OUTPUT STEM HOLE SIZE M

CODE	DIA.	PITCH	DEPTH
6	M 6	0.75	15
8	M 8	1.0	
1	M10	1.25	
D	M 6	1.0	
E	M 8	1.25	
F	M10	1.5	

unit: mm [inch]

M-SYSTEM
M-SYSTEM CO., LTD.

Your local representative:

Specifications are subject to change without notice. When ordering, use the latest data sheets available at M-System web site: