

MINIATURE MICROSWITCHES - POSITIVE BREAK

832607

- › Coil spring snap-action mechanism with wiping contacts
- › Positive opening action according to IEC 60947-5-1 Annex K
- › 6 A 250 V \sim max rating
- › Operating temperature -40 °C to +125 °C
- › Very long life
- › Extended range of terminals - Stainless steel actuators
- › cURus and CCC approved



Main specifications

Main specifications		Positive break 832607
Function	Connections	
I (changeover)	W2 (solder)	83260702
I (changeover)	W3 (QC 6.3x0.8)	83260704
I (changeover)	W6 (QC 4.8x0.5)	83260706
I (changeover)	W5 (screw + clamp)	●
I (changeover)	X1 (PCB, straight)	83260765
I (changeover)	X2 (PCB, rear)	83260768
I (changeover)	X3 (PCB, front)	83260708
R (normally closed)	W2 (solder)	83260701
R (normally closed)	W3 (QC 6.3x0.8)	83260703
R (normally closed)	W6 (QC 4.8x0.5)	83260705
R (normally closed)	W5 (screw + clamp)	●
R (normally closed)	X2 (PCB, rear)	83260732
R (normally closed)	X3 (PCB, front)	83260707
Electrical characteristics		
Positive opening action		→
Rating nominal / 250 V \sim (A)		6
Thermal current (I _{th}) (A)		10
Mechanical characteristics		
Maximum operating force (N)		4
Min. Release force (N)		1.5
Minimum positive opening force (N)		18
Max. Allowable overtravel force (N)		200
Rest position max. (mm)		15.7
Operating position (mm)		14.8 ^{+0.3}
Positive opening position (mm)		13.5
Maximum differential travel (mm)		0.3
Min. overtravel (mm)		1.3
Ambient operating temperature (°C)		-40 → +125
Mechanical life (operations)		10 ⁷
Contact gap (mm)		1.2
Weight (g)		7

Additional specifications

- Case: PET GF (UL 94-V0 / GWFI 960 °C / GWIT 775 °C)
- Button: PA66 GF (UL 94-V0 / GWFI 960 °C)
- Contacts: silver alloy
- Terminals: brass (except W2/X: copper nickel), silver plated common
- Levers: stainless steel, polyamide roller
- Degree of protection: IP40 (mechanism)
- Recommended actuating speed: 0.25 mm/s to 0.5 m/s
- Rated insulation voltage U_i: 250 V
- Impulse withstand voltage U_{imp}: 4 kV
- Certification marks:

Product adaptations



- › Special levers: special shapes and lengths
- › Lever mounted on position A for higher ratio
- › Special connections: angled, full wiring with custom connector....

Standard product

Product made to order



Contact us

Principles

Single break snap-action switch with positive opening action on NC contacts (1-2) according to IEC 60947-5-1 Annex K
 Changeover - SPDT (form C) Normally closed - SPST-NC (form B)

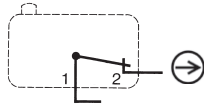
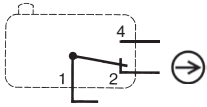

Curves

Electrical life

- Resistive load: 250 V \sim 6 A: 10^5 cycles
- Inductive load (IEC 60947-5-1): AC15: 250 V \sim 6 A: 0.3×10^5 cycles
 DC13: 24 V --- 20 W L/R = 40 ms: 3×10^5 cycles
 120 V --- 20W L/R = 40 ms: 5×10^5 cycles

Dimensions

Product

832607

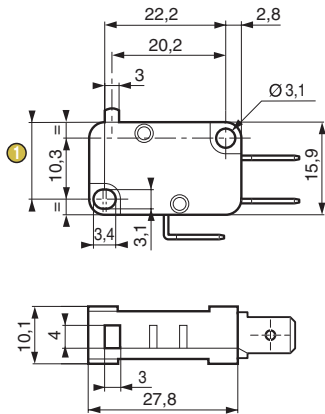

① Total travel position = 13.2 max.

Connections

W2 solder

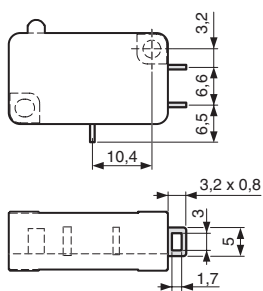

W3 quick-connect 6.3 x 0.8

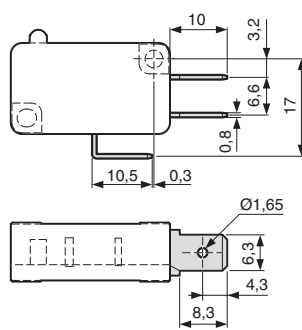

W5 screw with clamp

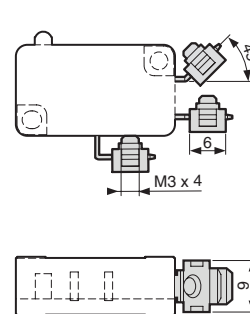

W6 quick-connect 4.8x0.5

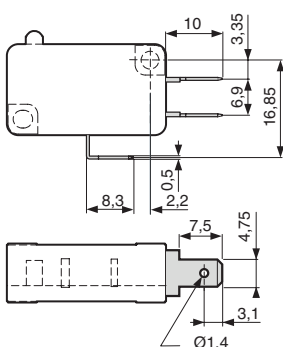

X1 for PCB, straight output

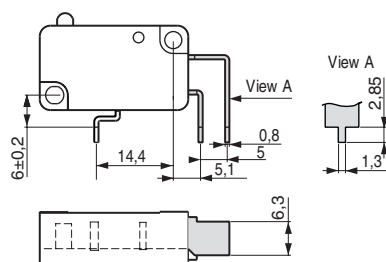

X2 for PCB, rear output

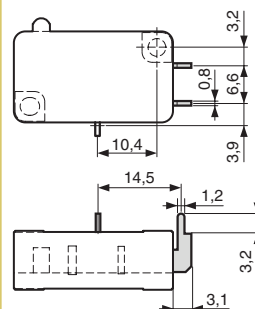

X3 for PCB, front output

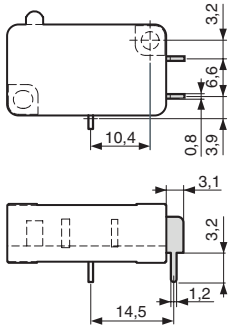

Actuator mounting position

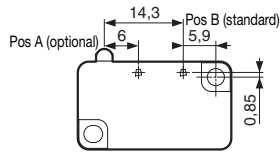

Actuators

260A flat

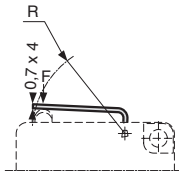

260E roller

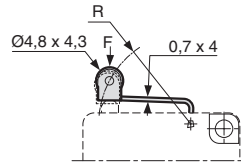

Other shapes and dimensions: consult us

Actuators and mounting accessories

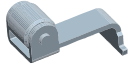
Actuators		Flat 260A R16.8	Roller 260E R16
			
Operating force - max.	N	4	4
Release force - min.	N	1	1
Min. positive opening force	N	18	18
Maximum rest position	mm	16.4	21.5
Operating position	mm	15.5 ±0.3	20.6 ±0.45
Positive opening position	mm	14.2	19.3
Maximum total travel position	mm	14.1	19.2

Levers are assembled in our factories

832607 microswitches with referenced actuators

	Actuators	260A R16.8 Pos B	206E R16 Pos B
832607	I W2	●	83260735
	I W3	●	83260710
	I W5	●	83260764
	I X3	●	83260736
	R W2	●	83260734
	R W3	●	83260711
	R W5	●	●
	R X3	●	83260714

Installation recommendations

See "Basic technical concepts"

How to order

Use the 8 digit part numbers when they are defined

Other cases, precise: Type of microswitch - Function - Connection - Actuator* - Fixing position*

* if needed

Example: 832607 R W2 260A R16.8 B

Standard product

Product made to order



Contact us

Warning:

The product information contained in this catalogue is given purely as information and does not constitute a representation, warranty or any form of contractual commitment. Crouzet Automatismes SAS and its subsidiaries reserve the right to modify their products without notice. It is imperative that we should be consulted over any particular use or application of our products and it is the responsibility of the buyer to establish, particularly through all the appropriate tests, that the product is suitable for the use or application. Under no circumstances will our warranty apply nor shall we be held responsible for any application (such as any modification, addition, deletion, use in conjunction with other electrical or electronic components, circuits or assemblies, or a **SENTRONIC AG** 056 222 38 18 mailbox@sentronic.com www.sentronic.com