

# Miniature

## → 83 137 0

- Operation by stainless steel wire
- Very low operating torque
- Long mechanical life

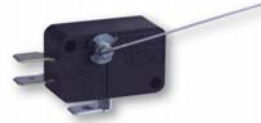

### Main specifications

		With standard rotary action 83 137 0
<b>Function</b>	<b>Connections</b>	
I (changeover)	W3	83 137 004
I (changeover)	W2	83 137 003
R (normally closed)	W2 - W3	●
C (normally open)	W2 - W3	●
<b>Electrical characteristics</b>		
Rating nominal / 250 V AC (A)		5
Rating thermal / 250 V AC (A)		14
<b>Mechanical characteristics</b>		
maximum operating torque N cm		0.12
Minimum release torque N cm		0.03
Overtravel torque N cm		0.5
Pre-travel- maximum (°)		26
Maximum differential travel (°)		14
Min. overtravel (°)		12
Ambient operating temperature (°C)		-20 → +125
Mechanical life (operations)		10 <sup>7</sup>
Contact gap (mm)		0.8
Weight (g)		7.2

### Additional specifications

#### Components

##### Material

- Case : polyamide.
- Contacts : silver.

##### Lever

- Stainless steel wire.

### Product adaptations



- Special levers
- Gold plated contacts
- Increased torque
- UL approval

## Principles

Single break changeover snap-action switch

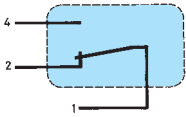

## Curves

Operating curve for type 83 137 0

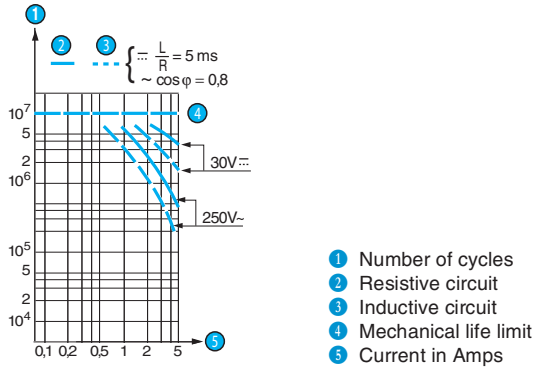

## Dimensions

### → Product

83 137 0

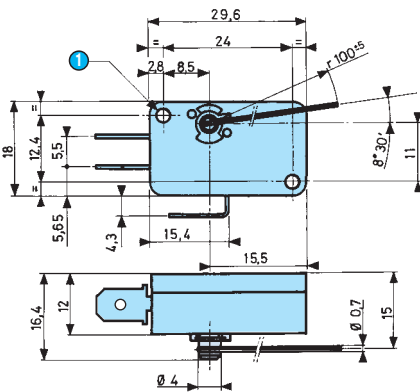

1 2 holes Ø 3.2

### → Connections

W2 solder

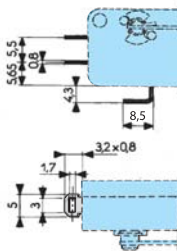

W3 for 6.35 mm clips

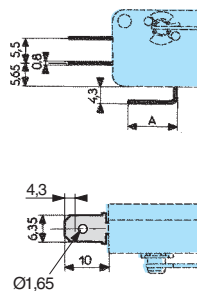

## Other information

### Mounting - Operation

See basic technical concepts